

# WHITES LANE AND MACKEY ST NEW PROVIDENCE/PARADISE ISLAND

<https://wateredgebahamas.com>

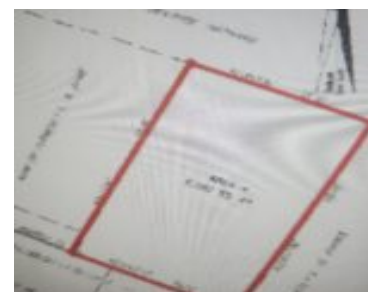

\$49,000



This Forclosure lot located on White lane just off Bar 20 corner is elevated lot boasting 6500sf. Community is close to public transportation, restaurants, schools, stores and much more. Directions - Pyfrom Road (also known as Bar 20 corner travel north on Mackey Street, turn through the 1st corner on the right hand side (Whites [...])

- 0 beds
- 0 baths
- Lots/Acreage
- Lots/Acreage
- For Sale Only
- 6500 sq ft

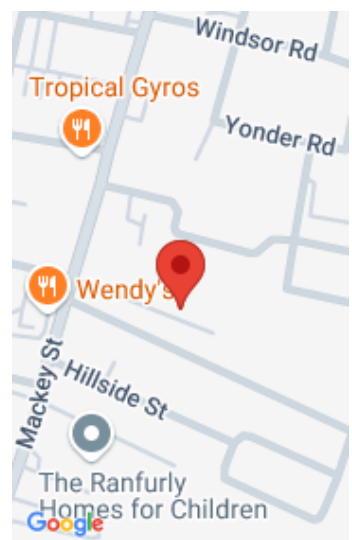

### Call us now

Phone: 242.424.4448  
 Email: [info@wateredgebahamas.com](mailto:info@wateredgebahamas.com)  
 Address: Nassau, Bahamas



## WaterEdge Realty

---

## Basics

**Location:** Mackey Street

**Lot Number:** 20

**Category:** Lots/Acreage

**Status:** For Sale Only

**Bathrooms:** 0 baths

**Lot size:** 6500 sq ft

**Island:** New Providence/Paradise Island

**Construction:** None

**Type:** Lots/Acreage

**Bedrooms:** 0 beds

**Area:** 6500 sq ft

---

## Property Features

**Amenities:** None

**Exterior Finish:** None

**Water:** None

**Foundation:** No

**Assessment Includes (Condo):** No Fee

**Style:** Single Family Lot

**Sewer:** Available

**Roof:** Other

**Air conditioning (Condo):** None

**Parking Type:** Open

---

## Rooms&Units Description

**Unit Number:** 20



### Call us now

Phone: 242.424.4448

Email: [info@wateredgebahamas.com](mailto:info@wateredgebahamas.com)

Address: Nassau, Bahamas



**WaterEdge  
Realty**