

SHIRLEY HEIGHTS COMMERCIAL BUILDING

<https://wateredgebahamas.com>

\$ 599,000.00

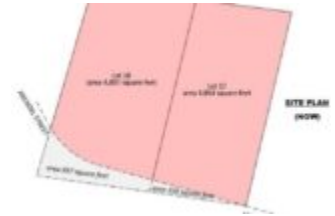

BANK DISTRESSED PROPERTY Prime commercial building centrally located on Arundel Street at the intersection of Mt. Royal Avenue in lovely Shirley Heights, consisting of two lots for a total of 9,761 sq. ft. This split level building has a front porch area and stair well and all windows are secured...



WaterEdge Realty Office

📞 242-424-4448

✉ info@wateredgebahamas.com

- Commercial - Building
- Commercial - Building
- For Sale, For Sale Only



CALL US NOW

Phone: 242-424-4448

Email: info@wateredgebahamas.com

Address: Bahamas



BASIC FACTS

Listing Number: C210601

Status: For Sale For Sale Only

Island: New Providence/Paradise Island

Living Area: 5,120 sq. ft.

Building Type: Commercial Building

Type: Commercial - Building

District: Central

Year built: 2004

Property Dimensions: 9,761 sq. ft.

- Central Air
- Partially Enclosed Yard



CALL US NOW

Phone: 242-424-4448

Email: info@wateredgebahamas.com

Address: Bahamas



**WaterEdge
Realty**