

# LOT 8 BLOCK 28 SERENITY NEW PROVIDENCE/PARADISE ISLAND

<https://wateredgebahamas.com>

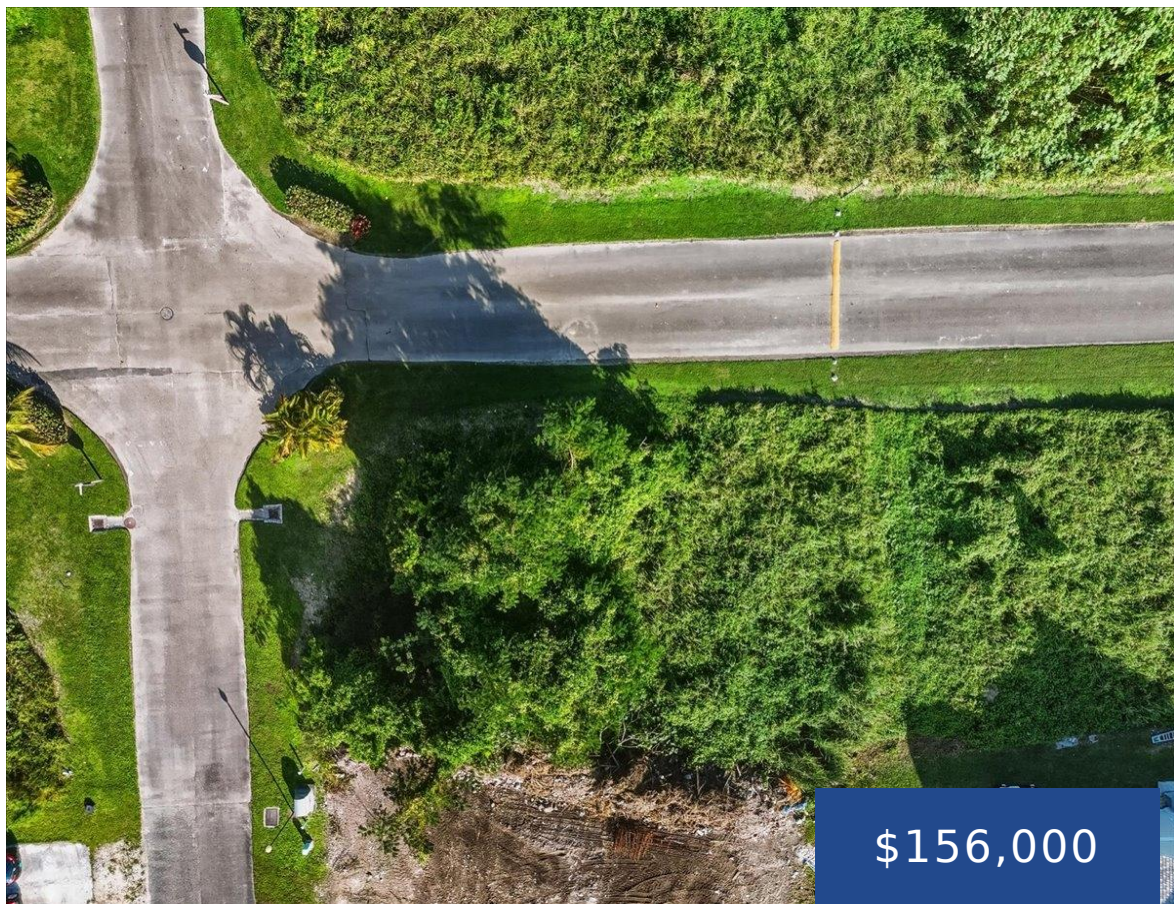

Prime residential lot situated within the exclusive gated community of Serenity, one of Western New Providence's most secure and well-maintained neighborhoods. This approximately 6,500 sq. ft. single-family parcel offers an excellent opportunity to build a custom home in a community known for strong property values, quality construction, and a family-focused environment. Serenity features 24-hour security, [...]

- 0 beds
- 0 baths
- Lots/Acreage
- Lots/Acreage
- For Sale Only
- 6506 sq ft



## Basics



### Call us now

Phone: 242.424.4448  
Email: [info@wateredgebahamas.com](mailto:info@wateredgebahamas.com)  
Address: Nassau, Bahamas



**WaterEdge  
Realty**

**Location:** Western Road

**Island:** New Providence/Paradise Island

**Lot Width:** 65

**Block:** 28

**Category:** Lots/Acreage

**Type:** Lots/Acreage

**Bedrooms:** 0 beds

**Area:** 6506 sq ft

**Subdivision:** Serenity

**Lot Number:** 8

**Lot Depth:** 100

**Construction:** None

**Total Finished Floor Area:** 6506

**Status:** For Sale Only

**Bathrooms:** 0 baths

**Lot size:** 6506 sq ft

---

## Property Features

**Amenities:** 24 Hour Security, Night Security

**Style:** Single Family Lot

**Sewer:** None

**Road:** Street

**Foundation:** No

**Outdoor Area (Condo):** None

**Parking Type:** Open

**Shared Amenities:** Clubhouse, Exercise Centre, Playground, Pool Outdoor, Recreation Centre, Tennis Court(s), Secured Entry

**Exterior Finish:** None

**Water:** City

**Roof:** Other

**Air conditioning (Condo):** None

**Assessment Includes (Condo):** Garbage Disposal

---

## Miscellaneous

**Legal Description:** Lot 8 block 28 Cypress Drive, Serenity, Nassau, Bahamas

**Site Influences:** Adult Oriented, Family Oriented, Highway Access, Shopping Nearby, Recreation Nearby, Quiet Area, Seniors Oriented, Road - Paved, Level Lot, Underground Services, Potential Recreation, Pets Allowed, Can Be Rented, Gated Community



### Call us now

Phone: 242.424.4448

Email: [info@wateredgebahamas.com](mailto:info@wateredgebahamas.com)

Address: Nassau, Bahamas



**WaterEdge  
Realty**