

# CARMICHAEL ROAD NEW PROVIDENCE/PARADISE ISLAND

<https://wateredgebahamas.com>

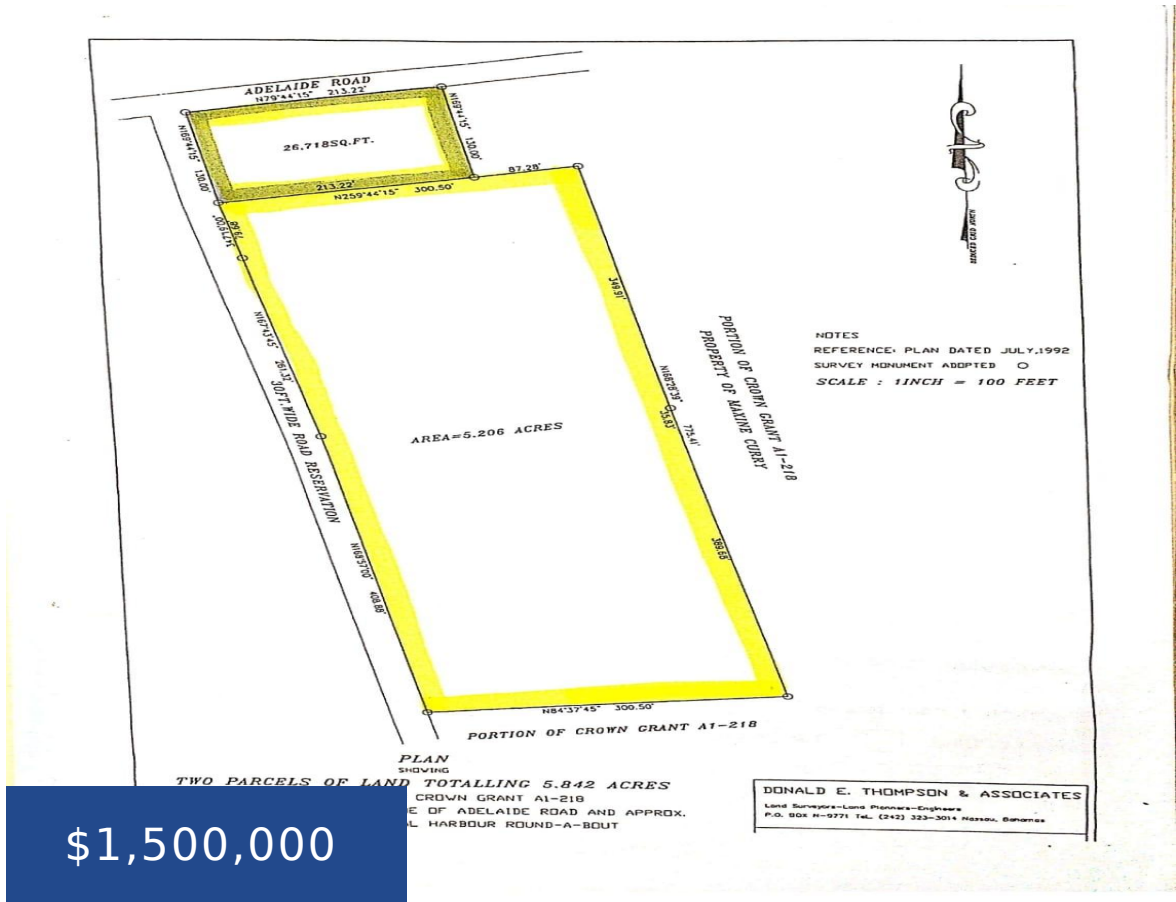

Great investment opportunity for subdivision development. The property comprises 5.6 acres and located on the property is 4 bed 4 bath 5000 sq. ft. home, as well as a fourplex apartment complex.

- Building and Land
- Acreage
- For Sale Only

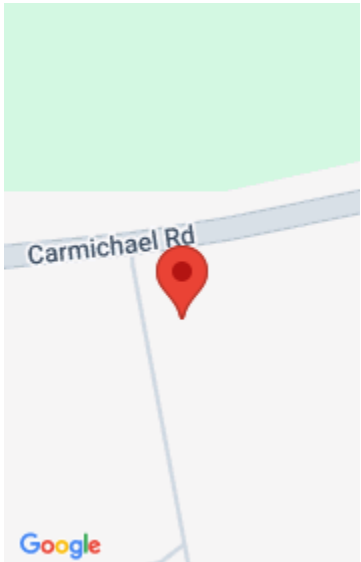

## Call us now

Phone: 242.424.4448  
Email: [info@wateredgebahamas.com](mailto:info@wateredgebahamas.com)  
Address: Nassau, Bahamas



**WaterEdge  
Realty**

---

## Basics

**Title of Property:** Carmichael Acreage

**Island:** New Providence/Paradise Island

**Type:** Building and Land

**Lot size:** 243936 sq ft

**Location:** Carmichael Road

**Category:** Acreage

**Status:** For Sale Only

---

## Miscellaneous

**Legal Description:** All that piece parcel or lot of land comprising 5.6 acres situated on Carmichael road.



### Call us now

Phone: 242.424.4448

Email: [info@wateredgebahamas.com](mailto:info@wateredgebahamas.com)

Address: Nassau, Bahamas



**WaterEdge  
Realty**