

# BLUE HILL ROAD ACREAGE

<https://wateredgebahamas.com>

\$ 697,500.00

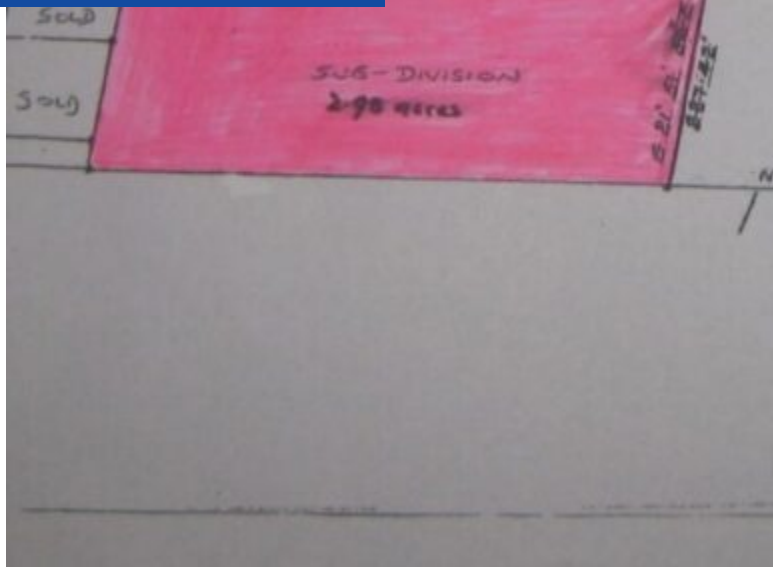

Prime acreage consisting of 2.98 acres in the Southern district, running along the family friendly community of Cowpen Road near the beach. This can be an ideal gated/non-gated Subdivision or condo development. This potential Subdivision comes with a 40' feet paved road in a fast growing urban neighborhood. This location can be accessed from South...

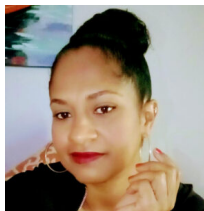

## Valderine Edgecombe

WaterEdge Realty

☎ 242-424-4448

✉ [val@wateredgebahamas.com](mailto:val@wateredgebahamas.com)

- Lots/Acreage, Luxury Development
- Lots/Acreage
- For Sale, For Sale Only



## CALL US NOW

Phone: 242-424-4448

Email: [info@wateredgebahamas.com](mailto:info@wateredgebahamas.com)

Address: Bahamas



## BASIC FACTS

**Listing Number:** VA111104

**Status:** For Sale For Sale Only

**Island:** New Providence/Paradise Island

**Type:** Lots/Acreage Luxury Development

**District:** Southern

**Living Area:** 2.98 acres

- Balcony
- Central Air
- Ductless Air System
- Enclosed Yard
- Multi Car Garage
- Outdoor Pool
- Porch
- Semi-furnished



### CALL US NOW

Phone: 242-424-4448

Email: [info@wateredgebahamas.com](mailto:info@wateredgebahamas.com)

Address: Bahamas

